

THIS DRAWING IS UNPUBLISHED. RELEASED FOR PUBLICATION 20
 © COPYRIGHT 20 BY TYCO ELECTRONICS CORPORATION. ALL INTERNATIONAL RIGHTS RESERVED.

LOC		DIST		REVISIONS			
P	LTR	DESCRIPTION	DATE	DWN	APVD		
-	-	A	RELEASED DRAWING	20DEC2010	K. J	X. X	

NOTES:

1. MATERIALS AND FINISH:
 -HOUSING; THERMAL PLASTIC, COLOR: WHITE
 -CONTACT: COPPER ALLOY, FINISH: TIN OVER NICKEL
2. MUST COMPLY WITH DIRECTIVE 2002/95/EC (ROHS)
3. RECOMMENDED SCREW SIZE: M3
 MAX SCREW DOWN TORQUE: 0.63 N.m
4. SCREWS FROM FERROUS METALS (OTHER THAN STAINLESS STEEL)
 SHOULD BE ZINC PLATED OR HAVE AN EQUIVALENT PROTECTIVE COATING
5. PACKAGING: SOFT TRAY

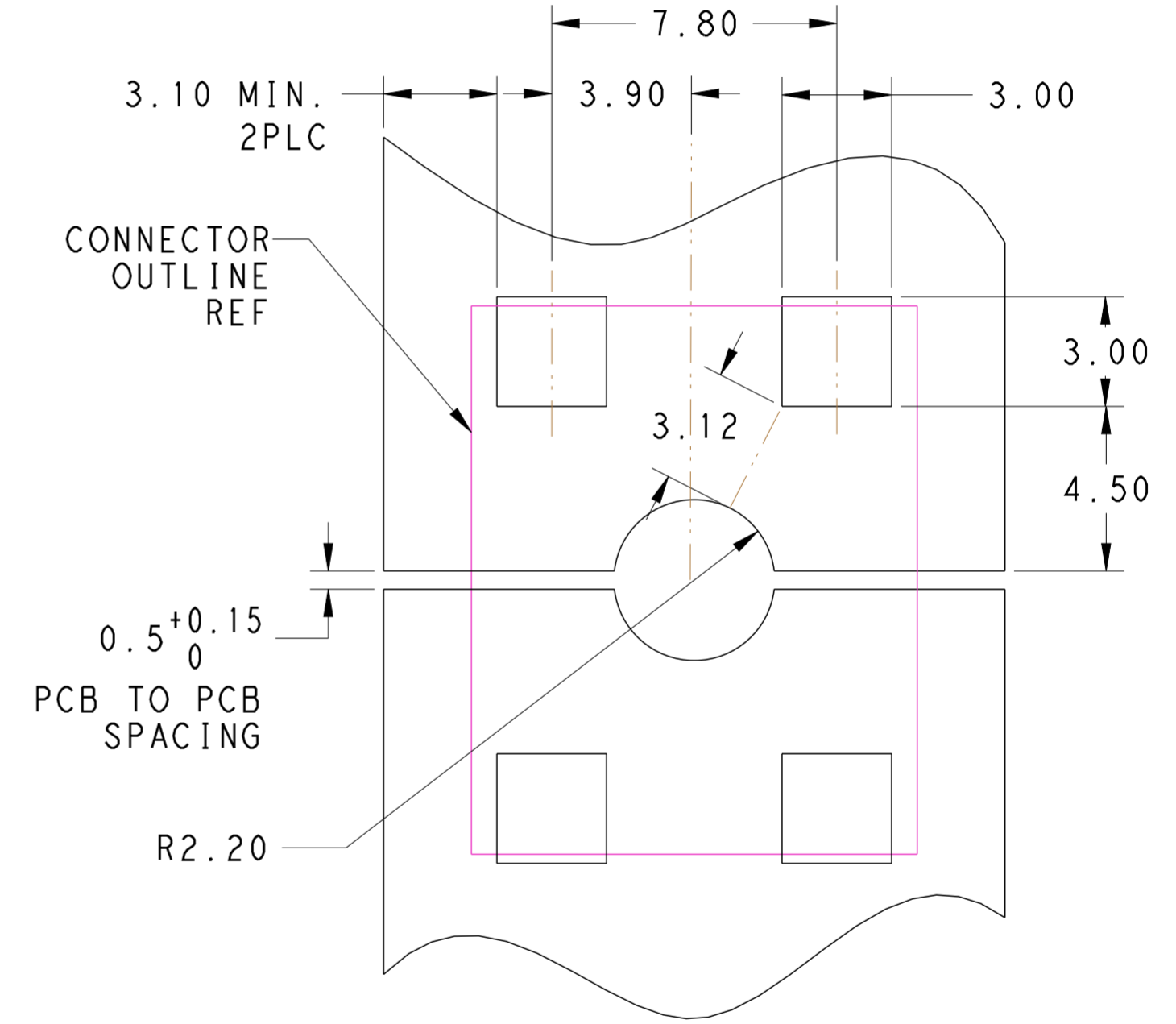
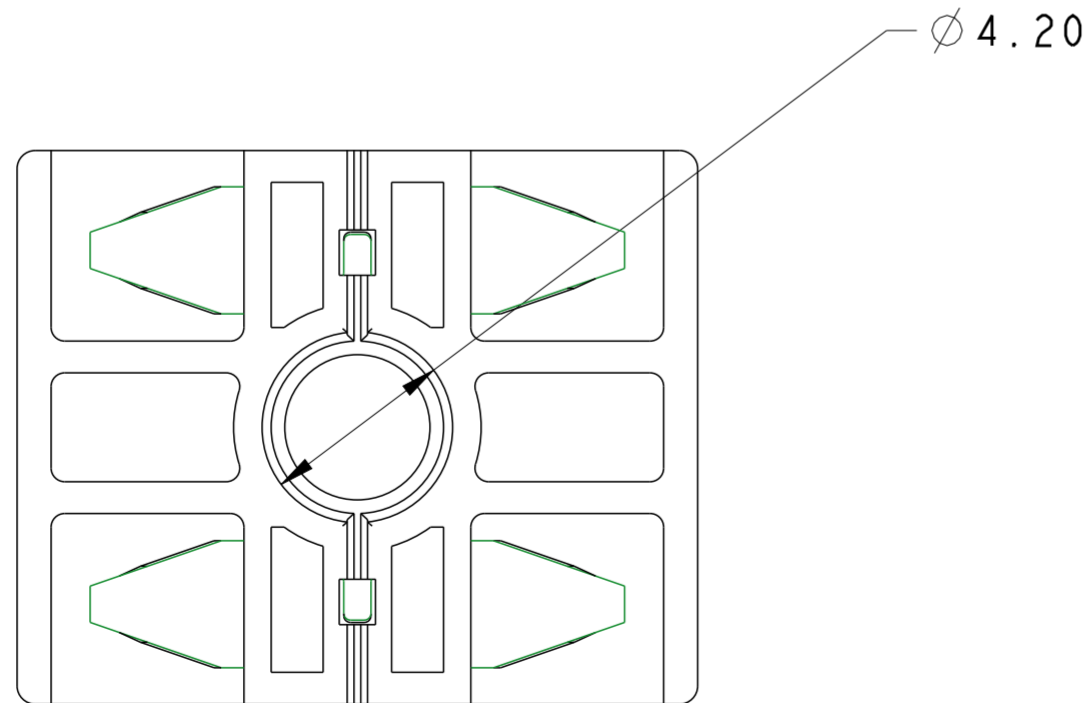
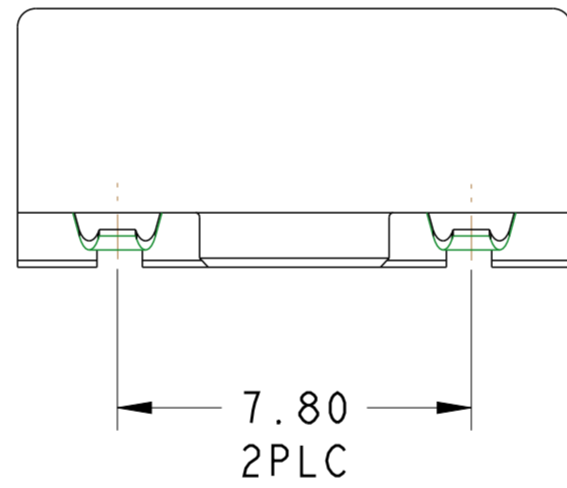
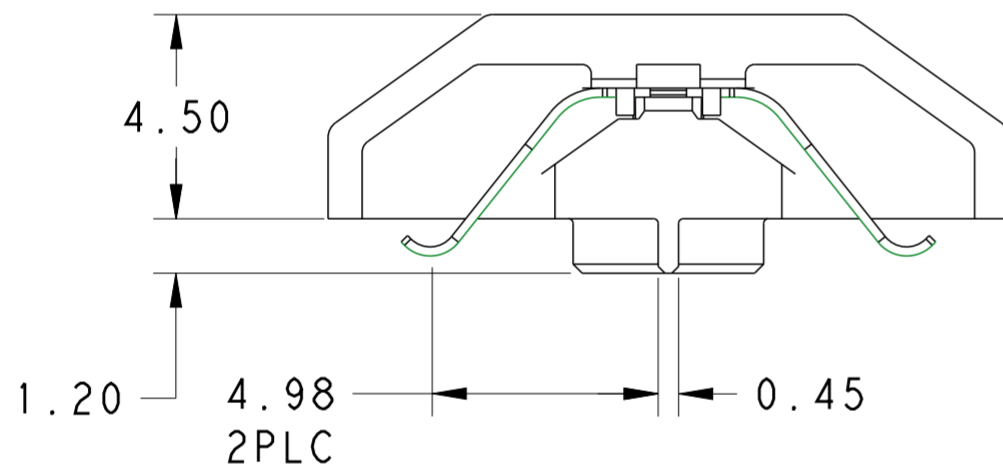
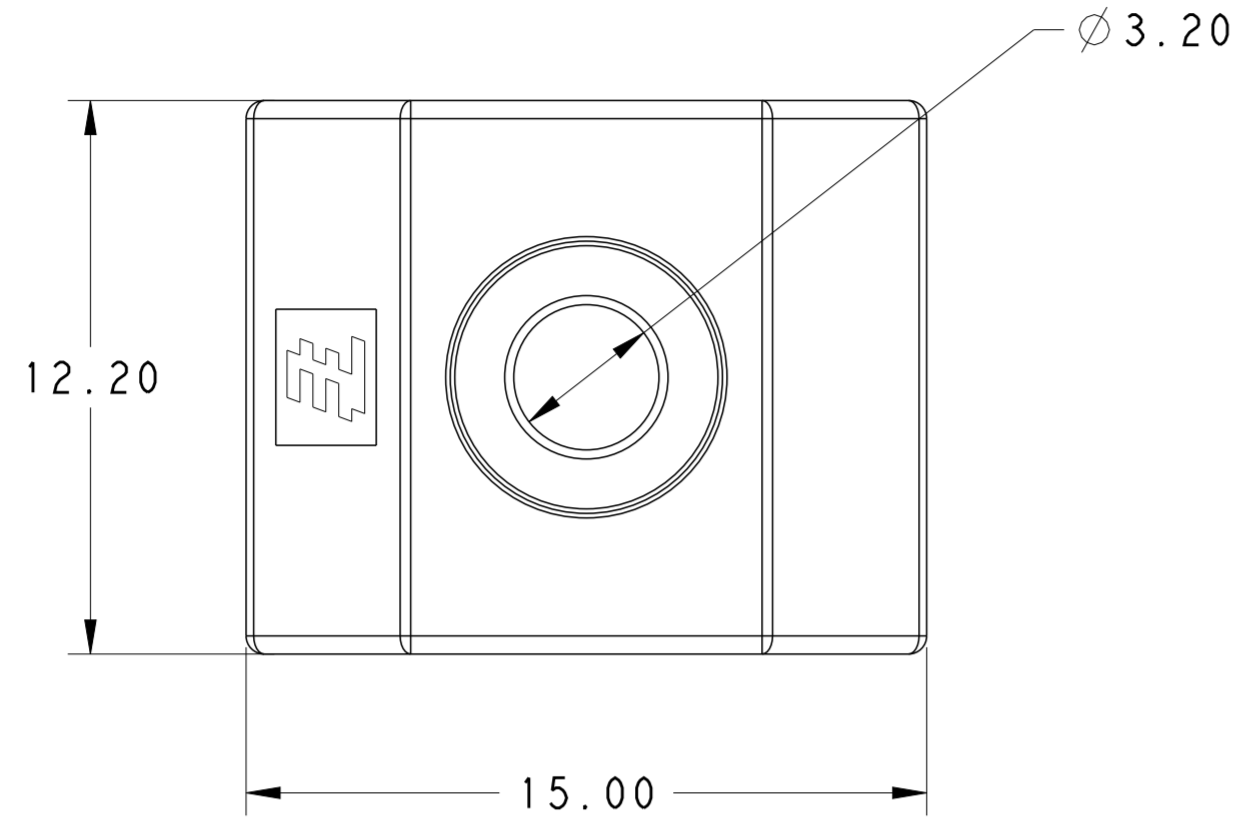

RECOMMENDED PCB LAYOUT
 SCALE 6:1

PART NO		2134347-1	
DWN KEVIN JIANG 20DEC2010		Tyco Electronics Corporation Shanghai, China	
CHK TRACY TAO 20DEC2010		NAME	
APVD XIANG XU 20DEC2010		MINI SCREW DOWN JUMPER B-B CONNECTOR	
SIZE	CAGE CODE	DRAWING NO	RESTRICTED TO
A2	00779	C-2134347	-
CUSTOMER DRAWING		SCALE 3:1	SHEET 1 OF 1 REV A

DIMENSIONS:		TOLERANCES UNLESS OTHERWISE SPECIFIED:	
mm		0 PLC	±
		1 PLC	±0.2
		2 PLC	±0.13
		3 PLC	±0.013
		4 PLC	±0.0001
MATERIAL		FINISH	
		±	